



APPENDIX



APPENDIX A: HEALTH AND HAPPINESS

HH1 and HH4

Table 1: Survey Results for Kanaal Baseline health and happiness.

Keeping in mind your activities and life circumstances, how would you rate your happiness?	Does your health allow you to meet your day-to-day needs?	Which aspect(s) of your health could be improved?
4	Yes	I want to do a 10k.
4	Yes	
4	Yes	Lower time-pressures
4	Yes	
4	Yes	
4	Yes	More active
5	Yes	Cardio
4	Yes	Mobility
5	Yes	Personal growth (always)
5	Yes	Relaxation
5	Yes	Fitness
5	Yes	

HH1, HH2, HH3 and HH4

Table 2: Survey Results for O 1st year health and happiness.

Keeping in mind your activities and life circumstances, how would you rate your happiness?	Does your health allow you to meet your day-to-day needs?	Which aspect(s) of your health could be improved?	Do you feel involved in the Zibi community?	If not, what initiatives would you like to see in order to become more actively involved?	Do you feel like you have a lot of opportunities to learn about different topics related to sustainability through Zibi?	What subjects would you be interested in learning more about?	How many neighbors do you know?	Are you a member of the Zibi Community Facebook group?	If not, why so?	If so, how do you plan on using the platform?
4	Yes		No		Yes		2-5	Yes		Participate in events
3	Yes	Stress-management	Yes		Yes		2-5	No	Have not had time to look into it.	I'm shy to post my ideas, I don't know how I could participate
5	Yes		Yes		Yes		2-5	Yes		Participate in events
4	Yes	Fitness	No	Board, neighbour meet-ups	Yes		2-5	Yes		Participate in events
5	Yes		Yes		Yes		2-5	No	Not really interested in FB	
5	Yes	Flexibility	Yes		Yes			No		I don't know how I could participate
4	No	Loss in weight and gain in overall fitness	Yes		Yes	More on updates/ progress on other buildings, their commercial tenants and how both the building and tenants support the vision.	2-5	Yes		Participate in events
4	Yes	Get better fitness	No	It seems like my schedule is often in conflict when there are activities	Yes		2-5	Yes		Participate in events

▼ Chart continued on next page

Keeping in mind your activities and life circumstances, how would you rate your happiness?	Does your health allow you to meet your day-to-day needs?	Which aspect(s) of your health could be improved?	Do you feel involved in the Zibi community?	If not, what initiatives would you like to see in order to become more actively involved?	Do you feel like you have a lot of opportunities to learn about different topics related to sustainability through Zibi?	What subjects would you be interested in learning more about?	How many neighbors do you know?	Are you a member of the Zibi Community Facebook group?	If not, why so?	If so, how do you plan on using the platform?
4	Yes	Social	No	Regular socials? Every social event has been on a Tuesday as long as I've been here and I play dodgeball Tuesday nights so I can never attend.	No	Any of them. I don't know what to say if I don't know the options.	1	Yes	I don't use Facebook	I don't know how I could participate
4	Yes	Weight	Yes		Yes	Greenhouse	1	No	Did not know there was one	I'm a bystander
4	Yes		No	Receive directly (and not through my landlord) information regarding activities and notices about the building...	No	How the energy system work exactly? What are Zibi's plans to set up better facilities for charging electric vehicles (in the Zibi development, not in the garage)?	2-5	No	I do not use Facebook because I do not trust what they do with the information they collect.	
3	Yes		No		No		1	No		I'm a bystander
5	Yes		Yes		Yes		2-5	No		I want to bring my ideas and solutions to my community
3	Yes		No	It is to early yet	No		2-5	No		
2	Yes	Mobility	No	Is there a community? Maybe a question when there are more people living there.	No	Not sure I saw much. More on our cork board or a sustainability vanity page would help me understand what I should know more about.	2-5	No	I don't subscribe to Facebook, don't get me started ;)	

▼ Chart continued on next page

HH5

Table 3: Survey Results for trades health and happiness.

1. In which trade do you work?	2. How would you describe your overall health (mental and physical combined)?					3. Based on your work experience, do you think that more could be done on construction sites to improve worker health?			4. Do you have any suggestions on initiatives or programs that could be done on Zibi's site to improve your health?	5. Before today's session, did you know that you were building Canada's most sustainable community?		6. How would you describe your awareness of sustainability issues and solutions?				
	Great	Good	Average	There's room for some improvement	There's room for significant improvement	Yes	No	No opinion		Yes	No	Great	Good	Average	There's room for some improvement	There's room for significant improvement
Carpentry		1				1					1			1		
Labour			1				1					1				
Carpentry		1				1			Better dust control			1				
Labour		1					1		No I do not have any suggestions	1			1			
Carpentry		1				1			Better ventilation, don't block exits	1				1		
Carpentry		1				1			Cords on ground everywhere			1				1
Carpentry	1					1			Use Dustbane Products or equivalent every time an area is swept. Ensure stairwells are always lit up.			1		1		
Carpentry		1				1			Air quality, washrooms			1			1	
Carpentry		1				1			Air quality, washrooms, cords off the ground.			1				1
Carpentry	1					1			Cords on floor	1					1	
Carpentry		1				1			Better housekeeping			1				1
Carpentry		1				1			Have appropriate labourers on site to maintain cleanliness of site. Coordinate so NO exits are blocked at the same times (MOL violation)							

▼ Chart continued on next page

1. In which trade do you work?	2. How would you describe your overall health (mental and physical combined)?					3. Based on your work experience, do you think that more could be done on construction sites to improve worker health?			4. Do you have any suggestions on initiatives or programs that could be done on Zibi's site to improve your health?	5. Before today's session, did you know that you were building Canada's most sustainable community?		6. How would you describe your awareness of sustainability issues and solutions?				
	Great	Good	Average	There's room for some improvement	There's room for significant improvement	Yes	No	No opinion		Yes	No	Great	Good	Average	There's room for some improvement	There's room for significant improvement
Carpentry				1		1			Not at the moment		1					
Carpentry		1				1				1			1			
Painter		1				1			Better organization		1				1	
Painter	1					1			Not organized	1			1			
Painter	1					1			Meilleur organisation du chantier		1				1	
Painter		1				1			Stylo Zibi		1				1	
Painter	1					1			Free parking, housekeeping		1		1			
Painter	1					1			Stationnement gratuit pour les travailleurs		1				1	
Demo		1					1		No	1			1			
Demo	1						1		No	1			1			
Demo	1						1			1			1			
Demo			1			1			No	1					1	
Labour			1					1		1					1	
Site Super		1				1					1		1			
Carpentry		1				1					1				1	
Carpentry		1					1				1		1			
Labour		1						1		1					1	
Carpentry		1						1		1			1			
Carpentry				1		1					1		1			
Sewer/water	1							1			1				1	
Carpentry		1						1		1			1			
Labour		1						1			1				1	

▼ Chart continued on next page

1. In which trade do you work?	2. How would you describe your overall health (mental and physical combined)?					3. Based on your work experience, do you think that more could be done on construction sites to improve worker health?			4. Do you have any suggestions on initiatives or programs that could be done on Zibi's site to improve your health?	5. Before today's session, did you know that you were building Canada's most sustainable community?		6. How would you describe your awareness of sustainability issues and solutions?				
	Great	Good	Average	There's room for some improvement	There's room for significant improvement	Yes	No	No opinion		Yes	No	Great	Good	Average	There's room for some improvement	There's room for significant improvement
Labour	1					1			Avoir des dîners d'appréciation avec les travailleurs		1					1
Formwork		1				1				1						1
Formwork	1					1					1					1
Formwork				1		1				1						1
Carpentry	1					1				1						1

HH5

Table 4: Survey Results for staff health and happiness.

Keeping in mind your activities and life circumstances, how would you rate your happiness?	Does your health allow you to meet your day-to-day needs?	Which aspect(s) of your health could be improved? More meditation.	Are you a member of the Zibi Community Facebook group?	If not, why so?	If so, how do you plan on using the platform?
4	No	I could be more physical	Yes		Participate in events, I'm a bystander
3	Yes	Energy, Stress	Yes		I'm a bystander
4	Yes		No		
3	Yes	Less sitting at a desk, more activity	No	Not a big fan of Facebook	
4	Yes	Sleep, exercise	No	I work here, so I get all the news through the grape vine.	
3	Yes	Stamina	No	Didn't know one existed	I'm a bystander
3	Yes	Less work stress, less alcohol intake, more sleep, more exercise	No	I don't participate in social media	
5	Yes	More stretching.	Yes		I'm a bystander
5	Yes	Dedicating more time to go to the gym	Yes		Participate in events
4	Yes	More active	No	Don't like Facebook	
4	Yes	Mental	Yes		Participate in events

APPENDIX B: EQUITY AND LOCAL ECONOMY

ELE5

Table 1: 2019 Event Overview

Date	Event	Event type	Number of attendees
Feb 21, 2019	Zero Carbon Talk	Zibi/One Planet	50
March 7, 2019	2019 Western Alumni Founder's Day	Private event	30
March 13, 2019	Snowshoe Evening	One Planet	13
March 28, 2019	Nordic City Solutions	Zibi hosted	50
April 27, 2019	Deep Therapy	Event rental	700
April 23, 2019	Zibi House Launch events	Zibi hosted	125
May 8, 2019	Container Gardening Workshop	One Planet	8
May 29, 2019	Bike Tune-Up	One Planet	11
June 1, 2019	Latin Sparks	Event rental	4,000
June 6, 2019	Festibière d'Été	Festival	35,000
June 9, 2019	Off Table test dinner	Zibi hosted	15
June 13, 2019	Moisson Outaouais Fundraiser	Fundraiser	60
July 19 to Sept 29, 2019	Terasse Festibière	Pop-up bar	4,000
July 25 to Sept 1, 2019	Bref,	Pop-up boutique	500
July 31 to Sept 1, 2019	Cirque du Soleil	Entertainment	97,000
Sept 13 to 15, 2019	LAVOLLEY	Festival	500
Sept 16, 2019	Maniwaki Native Friendship Centre Fundraiser	Zibi hosted	100
Sept 26, 2019	Honey extraction workshop	One Planet	16
Oct 26, 2019	Deep Therapy, Halloween	Event rental	700

▼ Chart continued on next page

Date	Event	Event type	Number of attendees
Oct 30, 2019	CREDDO	Event rental	60
Nov 8 and 9, 2019	Foinart: Live Jazz Nights	Event rental	150
Nov 20, 2019	Board game night	One Planet	8
Dec 5, 2019	Zipline Press Conference	Zibi hosted	300
Dec 11, 2019	O Condo turnover meeting	Zibi hosted	70
Dec 14, 2019	Altitude Gym Holiday Party	Event rental	80
Dec 31, 2019	Deep Therapy, NYE	Event rental	500
Total			144046

APPENDIX C: CULTURE & COMMUNITY

CC6 and CC7

Table 1: Survey Results for O residents environmental awareness and involvement.

How many neighbours do you know?	Are you a member of the Zibi Community Facebook group?	If not, why so?	If so, how do you plan on using the platform?	Would you say that your environmental awareness changed since living at Zibi?	What can Zibi do to improve environmental awareness? Check all that apply and elaborate if necessary.	Would you like to be more informed or to participate in more sustainability-focused activities?
2-5	Yes		Participate in events	My awareness of this issue has developed or has improved since living at Zibi.	Have monthly sustainability challenges, I'd love to see ashtray stations outside the building as many construction workers and management workers smoke and leave their cigarette butts on the ground in front of the building. This does not promote healthy living or a green community. Having the ashtrays will promote that and keep our community clean.	Maybe
2-5	No	Have not had time to look into it.	I'm shy to post my ideas, I don't know how I could participate	I was already aware of environmental issues and it did not evolve since living at Zibi.		Maybe
2-5	Yes		Participate in events	My awareness of this issue has developed or has improved since living at Zibi.		No
2-5	Yes		Participate in events	My awareness of this issue has developed or has improved since living at Zibi.	Organize, host or facilitate more activities that treat environmental issues and solutions., Have monthly sustainability challenges	Yes
2-5	No	Not really interested in FB		I was already aware of environmental issues and it did not evolve since living at Zibi.	Organize, host or facilitate more activities that treat environmental issues and solutions.	Yes
	No		I don't know how I could participate	I was already aware of environmental issues and it did not evolve since living at Zibi.		No
2-5	Yes		Participate in events	My awareness of this issue has developed or has improved since living at Zibi.	Distribute monthly newsletters, Organize, host or facilitate more activities that treat environmental issues and solutions., Have monthly sustainability challenges, More about the future buildings and commercial tenants to come	Maybe

▼ Chart continued on next page

How many neighbours do you know?	Are you a member of the Zibi Community Facebook group?	If not, why so?	If so, how do you plan on using the platform?	Would you say that your environmental awareness changed since living at Zibi?	What can Zibi do to improve environmental awareness? Check all that apply and elaborate if necessary.	Would you like to be more informed or to participate in more sustainability-focused activities?
2-5	Yes		Participate in events	My awareness of this issue has developed or has improved since living at Zibi.	You already do many post on the Zibi platform on Facebook, I read this and learn from it.	Maybe
1	Yes	I don't use Facebook	I don't know how I could participate	I was already aware of environmental issues and it did not evolve since living at Zibi.	Distribute monthly newsletters, Organize, host or facilitate more activities that treat environmental issues and solutions., Coordinate field trips, Bring in guest speakers, Have monthly sustainability challenges, Make Zibi community members and workers sign a personal pledge card	Yes
1	No	Did not know there was one	I'm a bystander	My awareness of this issue has developed or has improved since living at Zibi.	Bring in guest speakers, Have monthly sustainability challenges	Yes
2-5	No	I do not use Facebook because I do not trust what they do with the information they collect.		I was already aware of environmental issues and it did not evolve since living at Zibi.	Involve community members in caring for the site; inform about how environmental issues are being taken into account in all the work we see happening all over the place and how the buildings are using technology or other strategies to improve our environmental footprint.	Maybe
1	No		I'm a bystander	I was already aware of environmental issues and it did not evolve since living at Zibi.		Maybe
2-5	No		I want to bring my ideas and solutions to my community	I was already aware of environmental issues and it did not evolve since living at Zibi.	Distribute monthly newsletters	Maybe
2-5	No			I was already aware of environmental issues and it did not evolve since living at Zibi.	Coordinate field trips	Yes
2-5	No	I don't subscribe to Facebook, don't get me started ;)		I was already aware of environmental issues and it did not evolve since living at Zibi.	Please don't distribute newsletters to blindly recycle. Instead, seeing we are a 2 minute walk from the sales center with a scale model of the site put a schedule of activities up there indicating when/where those activities are if on site. Good for ambassadors living in O, people new to Zibi and staff who should know more.	Maybe

CC7

Table 2: Survey Results for staff environmental awareness and involvement.

Are you a member of the Zibi Community Facebook group?	If not, why so?	If so, how do you plan on using the platform?	Would you say that your environmental awareness changed since working at Zibi?	What can Zibi do to improve environmental awareness? Check all that apply and elaborate if necessary.	Would you like to be more informed or to participate in more sustainability-focused activities?
Yes		Participate in events, I'm a bystander	My awareness of this issue has developed or has improved since living at Zibi.	Continue with updating the FB page with content related to this topic	Yes
Yes		I'm a bystander	My awareness of this issue has developed or has improved since working at Zibi.	Organize, host or facilitate more activities that address sustainability issues and solutions., Coordinate field trips, Bring in guest speakers, Have monthly sustainability challenges, Make Zibi community members and workers sign a personal sustainability pledge card	Yes
No			My awareness of this issue has developed or has improved since working at Zibi.	Have monthly sustainability challenges	Maybe
No	Not a big fan of Facebook		I was already aware of environmental issues and it did not evolve since working at Zibi.	Organize, host or facilitate more activities that address sustainability issues and solutions., Coordinate field trips, Bring in guest speakers, Have monthly sustainability challenges	Yes
No	I work here, so I get all the news through the grape vine.		I was already aware of environmental issues and it did not evolve since working at Zibi.	Organize, host or facilitate more activities that address sustainability issues and solutions., Bring in guest speakers	Maybe
No	Didn't know one existed	I'm a bystander	I was already aware of environmental issues and it did not evolve since working at Zibi.	Distribute monthly newsletters, bring in guest speakers.	Maybe
No	I don't participate in social media		My awareness of this issue has developed or has improved since working at Zibi.	Organize, host or facilitate more activities that address sustainability issues and solutions., Coordinate field trips, Bring in guest speakers, Have monthly sustainability challenges	Yes
Yes		I'm a bystander	I was already aware of environmental issues and it did not evolve since working at Zibi.	Make Zibi community members and workers sign a personal sustainability pledge card	Yes
Yes		Participate in events	My awareness of this issue has developed or has improved since working at Zibi.	Organize, host or facilitate more activities that address sustainability issues and solutions., Have monthly sustainability challenges	Maybe
No	Don't like Facebook		My awareness of this issue has developed or has improved since working at Zibi.	Distribute monthly newsletters, Organize, host or facilitate more activities that address sustainability issues and solutions., Coordinate field trips, Bring in guest speakers, Have monthly sustainability challenges, Make Zibi community members and workers sign a personal sustainability pledge card	Yes
Yes		Participate in events	My awareness of this issue has developed or has improved since working at Zibi.	Distribute monthly newsletters, Organize, host or facilitate more activities that address sustainability issues and solutions., Coordinate field trips, Have monthly sustainability challenges	Maybe

CC7

Table 2: Survey Results for trade workers environmental awareness.

5. Before today's session, did you know that you were building Canada's most sustainable community?

6. How would you describe your awareness of sustainability issues and solutions?

Yes	Great
Yes	Great
Yes	Great
Yes	Great
Yes	Great
Yes	Great
Yes	Great
Yes	Good
Yes	Good
Yes	Good
Yes	Good
Yes	Good
Yes	Good
Yes	Good
Yes	Good
Yes	Good
Yes	Good
Yes	Good
No	Good
No	Good
No	Average
No	Average
No	Average
No	Average
No	Average
No	Average
No	Average
No	Average
No	Average
No	Average
No	Average

▼ Chart continued on next page

5. Before today's session, did you know that you were building Canada's most sustainable community?

6. How would you describe your awareness of sustainability issues and solutions?

No	Average
No	Average
No	Average
No	Average
No	Average
No	There's room for improvement
No	There's room for improvement
No	There's room for improvement
No	There's room for improvement
No	There's room for significant improvement

CC5

Table 2: Number of Memengweshii Council Meetings 2019. 10 official meetings were held in total for 2019; of which 6 meetings were conducted with full council, and 4 one-on-one meetings were conducted with individual Council members.

Date	Members present
January 28, 2019	Full Council
March 22, 2019	Full Council
April 3, 2019	Full Council
June 6, 2019	Full Council
July 7, 2019	Full Council
August 27, 2019	Full Council

APPENDIX D: LAND AND NATURE

LN2

Table 1: Site area dedicated to park space.

Site size	137,593 square meters		
14% park spaces target	19,263 square meters		
Pangishimo size	2500 square meters	13% of total park space at completion	2% of total Zibi site

LN2

Table 2: Baseline flora on Zibi site: there was a baseline total of 131 species on site, of which 62 were native species.

Scientific name	Common name	Status	Category
<i>Acer negundo</i>	Ash-leaved maple	E	A Nuisance for agriculture, horticultural production or forestry
<i>Acer platanoides</i>	Norway maple	EI	B Nuisance for the diversity of natural ecosystems or for the maintenance of ecosystem functions
<i>Agrostis gigantea</i>	Black bent	E	H Nuisance for ornamental horticulture or landscaping
<i>Alliaria petiolata</i>	Alliaire officinale	EI (B)	L Nuisance for leisure activities
<i>Alnus rugose</i>	Speckled alder	Native	S Nuisance for human and animal health
<i>Amelanchier arborea</i>	Downy serviceberry	E	E Exotic species
<i>Arabis glabra</i>	Tower mustard	E	EI Exotic and invasive species
<i>Aragrostis minor</i>	Lesser Love Grass	E	
<i>Archillea millefolium</i>	Comme yarrow	E	
<i>Arctium lappa</i>	Burdock	E	
<i>Arctium minus</i>	Lesser burdock	E	
<i>Aristida dichotoma</i>	Poverty grass	E	
<i>Asclepias syriaca</i>	Common milkweed	Native	

▼ Chart continued on next page

Scientific name	Common name	Status	Category
<i>Acer negundo</i>	Ash-leaved maple	E	A Nuisance for agriculture, horticultural production or forestry
<i>Acer platanoides</i>	Norway maple	EI	
<i>Agrostis gigantea</i>	Black bent	E	B Nuisance for the diversity of natural ecosystems or for the maintenance of ecosystem functions
<i>Alliaria petiolata</i>	Alliaire officinale	EI (B)	
<i>Alnus rugose</i>	Speckled alder	Native	H Nuisance for ornamental horticulture or landscaping
<i>Amelanchier arborea</i>	Downy serviceberry	E	L Nuisance for leisure activities
<i>Arabis glabra</i>	Tower mustard	E	S Nuisance for human and animal health
<i>Aragrostis minor</i>	Lesser Love Grass	E	E Exotic species
<i>Archillea millefolium</i>	Comme yarrow	E	EI Exotic and invasive species
<i>Arctium lappa</i>	Burdock	E	
<i>Arctium minus</i>	Lesser burdock	E	
<i>Aristida dichotoma</i>	Poverty grass	E	
<i>Asclepias syriaca</i>	Common milkweed	Native	
<i>Aster so.</i>	Aster		
<i>Barbarea vulgaris</i>	Yellow rocket	E	
<i>Brassica nigra</i>	Black mustard	E	
<i>Bromus inermis ssp.inermis</i>	Awnless brome grass	EI	
<i>Catalpa speciosa</i>	Northern catalpa	E	
<i>Cerastium arvense ssp. Arvense</i>	Meadow chickweed	E	
<i>Chrysanthemum leucanthemum</i>	Ox-eye daisy	E	
<i>Cirsium arvense</i>	Canada thistle	Native	
<i>Cirsium vulgare</i>	Bull thistle	E	
<i>Cornus sericea</i>	Red twig dogwood	Native	
<i>Cornus stolonifera</i>	Red-osier dogwood	Native	
<i>Cynanchum rossicum</i>	Swallow-wort	E	
<i>Dactylis glomerata</i>	Orchard grass	E	
<i>Daucus carota</i>	Wild Carrot	E	
<i>Diervilla lonicera</i>	Bush-honeysuckle	Native	
<i>Echium vulgare</i>	Viper's bugloss	E	
<i>Elymus repens</i>	Quackgrass	EI (A)	
<i>Epipactis helleborine</i>	Broadleaf helleborine	E	

▼ Chart continued on next page

Scientific name	Common name	Status	Category
<i>Erigeron annuus</i>	Daisy fleabane	Native	A Nuisance for agriculture, horticultural production or forestry
<i>Euphorbia cyparissias</i>	Cypress spurge	E	B Nuisance for the diversity of natural ecosystems or for the maintenance of ecosystem functions
<i>Festuca</i>	Blue fescue	Native	H Nuisance for ornamental horticulture or landscaping
<i>Fragaria virginiana</i>	Scarlet strawberry	Native	L Nuisance for leisure activities
<i>Frangula alnus</i>	Alder buckthorn	E (A+B)	S Nuisance for human and animal health
<i>Fraxinus americana</i>	Biltmore ash	Native	E Exotic species
<i>Fraxinus pennsylvanica</i>	Green ash	Native	EI Exotic and invasive species
<i>Galium aparine</i>	Cleavers	E	
<i>Galium mollugo</i>	Smooth bedstraw	EI (A+B)	
<i>Galium sp.</i>	Catchweed bedstraw	Native	
<i>Geranium bicknellii</i>	Bicknell's crane's-bill	Native	
<i>Geum canadense</i>	White avens	Native	
<i>Gleditsia triacanthos var. inermis</i>	Ornamental thornless honey locust (Shademaster)	E	
<i>Hieracium aurantiacum</i>	Orange Hawkweed	E	
<i>Hypericum perforatum</i>	St John's wort	E	
<i>Impatiens capensis</i>	Spotted jewelweed	Native	
<i>Juniperus virginiana</i>	Eastern redcedar	Native	
<i>Lamium amplexicaule</i>	Henbit	E	
<i>Laportea canadensis</i>	Canada nettle	Native	
<i>Leonurus cardiaca</i>	Motherwort	E	
<i>Linaria vulgaris</i>	Butter-and-eggs	E	
<i>Lonicera canadensis</i>	Canadian fly honeysuckle	Native	
<i>Lonicera tatarica</i>	Tartarian honeysuckle	E	
<i>Lotus corniculatus</i>	Bird's-foot trefoil	E	
<i>Medicago lupulina</i>	Hop-clover	E	
<i>Melilotus albus</i>	Sweet clover	E	
<i>Mentha arvensis</i>	Wild mint	Native	
<i>Myosotis laxa</i>	Small forget-me-not	Native	
<i>Nepeta cataria</i>	Catnip	E	
<i>Oenothera biennis</i>	Evening primrose	Native	
<i>Oxalis dillenii</i>	Common yellow wood-sorrel	Native	

▼ Chart continued on next page

Scientific name	Common name	Status	Category
<i>Panicum acuminatum</i> var. <i>acuminatum</i>	Acuminate panic grass	Native	A Nuisance for agriculture, horticultural production or forestry
<i>Panicum capillar</i>	Witch grass	Native	
<i>Parthenocissus inserta</i>	Grape-woodbine	Native	B Nuisance for the diversity of natural ecosystems or for the maintenance of ecosystem functions
<i>Parthenocissus quinquefolia</i>	Virginia creeper	E	
<i>Parthenocissus vitacea</i>	Vigne vierge commune	Native	H Nuisance for ornamental horticulture or landscaping
<i>Persicaria virginiana</i>	Thicket creeper	Native	L Nuisance for leisure activities
<i>Phalaris arundinacea</i>	Gardener's-garters	EI (B)	S Nuisance for human and animal health
<i>Picea abies</i>	Norway spruce	E	E Exotic species
<i>Picea glauca</i>	White spruce	Native	
<i>Pinus banksiana</i>	Jack pine	Native	EI Exotic and invasive species
<i>Pinus nigra</i>	Austrian pine	E	
<i>Pinus resinosa</i>	Red pine	Native	
<i>Pinus strobus</i>	Eastern white pine	Native	
<i>Pinus sylvestris</i>	Scot's pine	E	
<i>Plantago lanceolata</i>	Narrow-leaved plantain	E	
<i>Plantago major</i>	Broad-leaved plantain	E	
<i>Poa compressa</i>	Canada bluegrass	E	
<i>Poa pratensis</i>	Kentucky blue grass	E	
<i>Poacea</i> sp.	Grass	Native	
<i>Polygonum cuspidatum</i>	Japanese knotweed	E	
<i>Populus balsamifera</i>	Balsam-poplar	Native	
<i>Populus deltoides</i>	Eastern cottonwood	Native	
<i>Populus tremuloides</i>	Quaking aspen	Native	
<i>Populus x canadensis</i>	Carolina Poplar (Pcar)	Native	
<i>Potentilla argentea</i>	Hoary cinquefoil	E	
<i>Potentilla norvegica</i>	Rough cinquefoil	Native	
<i>Potentilla recta</i>	Sulfur cinquefoil	E	
<i>Prunella vulgaris</i>	Common self-heal	Native	
<i>Prunus pensylvanica</i>	Bird cherry	Native	
<i>Prunus serotina</i>	Black cherry	Native	
<i>Prunus virginiana</i>	Choke cherry	Native	

▼ Chart continued on next page

Scientific name	Common name	Status	Category
<i>Quercus macrocarpa</i>	Bur oak	Native	A Nuisance for agriculture, horticultural production or forestry
<i>Ranunculus acris</i>	Tall buttercup	E	B Nuisance for the diversity of natural ecosystems or for the maintenance of ecosystem functions
<i>Rhamnus cathartica</i>	Buckthorn	EI (A+B+S)	H Nuisance for ornamental horticulture or landscaping
<i>Rhamnus frangula</i>	Glossy buckthorn	E	L Nuisance for leisure activities
<i>Rhus aromatica</i>	Fragrant sumac	Native	S Nuisance for human and animal health
<i>Rhus typhina</i>	Staghorn sumac	Native	E Exotic species
<i>Rubus idaeus</i>	Wild red raspberry	E	EI Exotic and invasive species
<i>Rumex crispus</i>	Curled dock	E	
<i>Salix dicolor</i>	Pussy willow	Native	
<i>Sambucus racemosa</i>	Red elderberry	Native	
<i>Saponaria officinalis</i>	Wild sweet William	E	
<i>Sedum acre</i>	Mossy stonecrop	E	
<i>Silene vulgaris</i>	Bladder silene	E	
<i>Solanum dulcamara</i>	Bittersweet nightshade	E	
<i>Solidage canadensis</i>	Canada goldenrod	Native	
<i>Solidago altissima</i>	Goldenrod	Native	
<i>Sonchus arvensis</i> ssp. <i>Arvensis</i>	Field sow thistle	E	
<i>Symphotrichum novae-angliae</i>	New England aster	Native	
<i>Tanacetum vulgare</i>	Tansy	E	
<i>Taraxacum officinale</i>	Common dandelion	E	
<i>Thuja occidentalis</i>	Northern white-cedar	Native	
<i>Tilia americana</i>	American basswood	Native	
<i>Toxicodendron radicans</i>	Poison ivy	Native	
<i>Trifolium agrarium</i>	Low Hop Clover	E	
<i>Trifolium repens</i>	White clover	EI (A)	
<i>Tsuga canadensis</i>	Hemlock	Native	
<i>Turritis glabra</i>	Tower rockcress	Native	
<i>Ulmus americana</i>	White elm	Native	
<i>Ulmus pumila</i>	Siberian elm	E	
<i>Ulmus rubra</i>	Red elm	Native	
<i>Verbascum thapsus</i>	Common mullein	E	

▼ Chart continued on next page

Scientific name	Common name	Status	Category
<i>Viburnum nudum</i> var. <i>cassinoides</i>	White-rod	Native	A Nuisance for agriculture, horticultural production or forestry
<i>Viburnum opulus</i> subsp. <i>Trilobum</i> var. <i>amerianum</i>	American cranberrybush	Native	
<i>Vicia cracca</i>	Tufted vetch	EI (A)	B Nuisance for the diversity of natural ecosystems or for the maintenance of ecosystem functions
<i>Vincetoxicum rossicum</i>	Swallowwort	E	
<i>Viola</i> sp.	Pansy	Native	H Nuisance for ornamental horticulture or landscaping
<i>Vitis riparia</i>	Riverbank grape	Native	L Nuisance for leisure activities
<i>Xanthium strumarium</i>	Cocklebur	Native	
			S Nuisance for human and animal health
			E Exotic species
			EI Exotic and invasive species

LN2

Table 2: List of plants that are culturally significant to the Algonquin Anishinabe.

Scientific name	Current name
<i>Abies balsamea</i>	Balsam Fir
<i>Acer pensylvanicum</i>	Striped Maple
<i>Acer rubrum</i>	Red Maple
<i>Acer saccharinum</i>	Silver Maple
<i>Acer saccharum</i>	Sugar Maple
<i>Achillea millefolium</i>	Yarrow
<i>Aesculus glabra</i>	Ohio Buckeye
<i>Aeslepias incarnata</i>	Swamp Milkweed
<i>Aeslepias syrica</i>	Common Milkweed
<i>Agastache foeniculum</i>	Anise Hyssop
<i>Allium cernuum</i>	Nodding Onion
<i>Amelanchier alnifolia</i>	Saskatoon Berry
<i>Amelanchier canadensis</i>	Serviceberry
<i>Anaphalis margaritacea</i>	Pearly Everlasting
<i>Anemone canadensis</i>	Canada Anemone
<i>Aquilegia canadensis</i>	Wild Columbine

▼ Chart continued on next page

Scientific name	Current name
<i>Archtostaphylos uva-ursi</i>	Bearberry
<i>Arisaema triphyllum</i>	Jack-in-the-Pulpit
<i>Artemisia ludoviciana</i>	Sagebrush
<i>Aster divaricatus</i>	White Wood Aster
<i>Betula alleghaniensis</i>	Yellow Birch
<i>Betula papyrifera</i>	Paper Birch
<i>Betula populifolia</i>	Gray Birch
<i>Bouteloua curtipendula</i>	Sideoats Grama
<i>Carya ovata</i>	Shagbark Hickory
<i>Celtis occidentalis</i>	Hackberry
<i>Cercis canadensis</i>	Eastern Redbud
<i>Comtonia peregrina</i>	Sweet Fern
<i>Coptis trifolia</i>	Goldthread
<i>Cornus canadensis</i>	Bunchberry
<i>Cornus stolonifera</i>	Red Osier Dogwood, Red Willow
<i>Echinacea purpurea</i>	Purple Coneflower
<i>Elymus canadensis</i>	Canada Wild Rye
<i>Epilobium angustifolium</i>	Fireweed
<i>Equisetum hyemale</i>	Scouring Rush
<i>Eupatorium maculatum</i>	Joe Pye Weed
<i>Fagus grandifolia</i>	American Beech
<i>Fragaria virginiana</i>	Common Strawberry
<i>Gaultheria procumbens</i>	Wintergreen
<i>Geranium maculatum</i>	Wild Geranium
<i>Gymnocladus dioicus</i>	Kentucky Coffee Tree
<i>Heliopsis helianthoides</i>	False Sunflower
<i>Hierochloe odorata</i>	Sweetgrass
<i>Ilex verticulata</i>	Winterber
<i>Juglans cinerea</i>	Butternut
<i>Juglans nigra</i>	Black Walnut
<i>Juniperus communis</i>	Common Juniper

▼ Chart continued on next page

Scientific name	Current name
<i>Larix laricina</i>	Tamarack
<i>Lobelia inflata</i>	Tobacco spp
<i>Lobelia siphilitica</i>	Great Blue Lobelia
<i>Matteuccia struthiopteris</i>	Ostrich Fern
<i>Mentha arvensis</i>	Wild Mint
<i>Monarda fistulosa</i>	Wild Bergamot
<i>Oenothera biennis</i>	Common Evening Primrose
<i>Osmunda cinnamomea</i>	Cinnamon Fern
<i>Ostrya virginiana</i>	Ironwood
<i>Picea glauca</i>	White Spruce
<i>Picea mariana</i>	Black Spruce
<i>Pinus resinosa</i>	Red Pine
<i>Pinus strobus</i>	Eastern White Pine
<i>Populus grandidentata</i>	Bigtooth Aspen
<i>Populus tremuloides</i>	Trembling Aspen
<i>Prunella vulgaris</i>	Prunella (Heal-All)
<i>Prunus pensylvanica</i>	Pin Cherry
<i>Prunus virginiana</i>	Choke Cherry
<i>Quercus alba</i>	White Oak
<i>Quercus macrocarpa</i>	Burr Oak
<i>Quercus rubra</i>	Red Oak
<i>Rhododendron groenlandicum</i>	Labrador Tea
<i>Rhus typhina</i>	Staghorn Sumac
<i>Rosa acicularis</i>	Prickly Wild Rose
<i>Rudbeckia hirta</i>	Black Eyed Susan
<i>Salix discolor</i>	Pussy Willow
<i>Salix lucida</i>	Yellow Willow, Shining Willow
<i>Salix nigra</i>	Black Willow
<i>Salvia officinalis</i>	Common Sage
<i>Sambucus canadensis</i>	American Elder
<i>Sarracenia purpurea</i>	Pitcher Plant

▼ Chart continued on next page

Scientific name**Current name**

<i>Schizachyrium scorparium</i>	Little Bluestem
<i>Smilancina racemosa</i>	False Soloman's Seal
<i>Sorghastum nutans</i>	Indian Grass
<i>Spirea alba</i>	Meadowsweet
<i>Spirea tomentosa</i>	Steeplebush
<i>Sporobolus herterolepis</i>	Prairie Dropseed
<i>Symphyotrichum cordifolium</i>	Heart-Leaved Aster
<i>Symphyotrichum novae-angeliae</i>	New England Aster
<i>Symphytum officinale</i>	Comfrey
<i>Thuja occidentalis</i>	Eastern White Cedar
<i>Tilia americana</i>	Basswood
<i>Tradescantia ohiensis</i>	Spiderwort
<i>Trillium erectum</i>	Red Trillium
<i>Trillium grandiflorum</i>	White Trillium
<i>Tsuga canadensis</i>	Eastern Hemlock
<i>Viburnum cassinoides</i>	Wild Raisin/Witherod
<i>Viburnum trilobum</i>	High Bush Cranberry

LN4

Table 4: Plant list from Wàsa Zibi Plaza packages: there is now a total of 17 native species added to the site, which represents 27% of the original native biodiversity on site.

Scientific name	Current name	Culturally or historically significant
<i>Abies balsamea</i>	Balsam fir	x
<i>Acer rubrum</i>	Red Maple	x
<i>Acer saccharum</i>	Sugar Maple	x
<i>Amelanchier canadensis</i>	Serviceberry	x
<i>Calamagrostis canadensis</i>	Canada bluejoint	
<i>Carex pensylvanica</i>	Oak sedge	
<i>Celtis occidentalis</i>	Common hackberry	
<i>Deschampsia caespitosa</i>	Tufted hair grass	
<i>Diervilla lonicera</i>	Bush honeysuckle	
<i>Fagus frandifolia</i>	American beech	x
<i>Heliopsis helianthoides</i>	False sunflower	x
<i>Pinus strobus</i>	Eastern white pine	x
<i>Populus grandidentata</i>	Bigtooth aspen	x
<i>Populus tremuloides</i>	Quaking aspen	
<i>Quercus macrocarpa</i>	Burr Oak	x
<i>Schizachyrium scoparium</i>	Little bluestem	x
<i>Sporobolus heterolepis</i>	Prairie dropseed	x

LN4

Table 5: O residents' time spent in nature; a total of 3/15 of the residents felt like their time in nature has increased since living at Zibi. 10/15 residents expressed some kind of interest in having their own garden space, which would be an effective initiative to increase the amount of time spent in nature by all.

Has your time in nature increase since living at Zibi?

Would you be interested in having your own garden space ran by a residents' gardening committee?

No	Yes
No	Maybe
No	Yes
No	Maybe
No	Maybe
No	No
No	Maybe
No	Yes
No	Maybe
No	No
No	No
No	Maybe
Yes	No
Yes	Yes
Yes	No

APPENDIX E: SUSTAINABLE WATER

SW1

Table 1: Efficiency of fixtures installed in suites in Condominium O.
Coloured rows indicate compliance with One Planet Living Design specifications.

Average flow rate

Kitchen faucet	5.7 L/min
Lavatory faucet	5.7 L/min
All showers	6.62 L/min
All toilets	4.8 L/min

SW1

Table 2: Efficiency of fixtures installed in commercial Block 2/3.
Coloured rows indicate compliance with One Planet Living Design specifications.

Average flow rate

Toilet	4.8 LPF (1.28 GPF)
Urinal	0.125 GPF
Faucet	0.5 GPM (1.9 L/min)
Shower	1.5 GPM
Accessible shower	9.5 L/min (2.5 GPM) with reducer to 1.5 GPM

APPENDIX F: LOCAL AND SUSTAINABLE FOOD

LSF2 and LSF3

Table 1: O residents: 10/15 residents expressed some kind of interest in having their own garden space, which would be an effective initiative to increase the amount of time spent in nature by all. 1/3 of surveyed residents claim to purchase at least 25% of their food (by value) that is organic, or local, or Fair Trade. 2/15 of surveyed residents claim to be participating in a CSA program.

Would you be interested in having your own garden space ran by a residents' gardening committee	What percentage of food you consume is either from local, Fairtrade or organic sources?	In the last year, have you been registered in a CSA or farm-to-table program?
Maybe	0%	No
Maybe	1-25%	No
Maybe	1-25%	No
Maybe	1-25%	No
Maybe	1-25%	No
No	1-25%	No
No	1-25%	No
No	1-25%	No
Yes	1-25%	No
Yes	1-25%	No
Maybe	26-50%	No
No	26-50%	Yes
No	51-75%	No
Yes	51-75%	Yes
Yes	51-75%	No

LSF2 and LSF3

Table 2: Staff: 6/11 of the surveyed staff claim to purchase at least 25% of their food (by value) that is organic, or local, or Fair Trade. 3/11 of surveyed staff participate in a CSA program.

What percentage of food you consume is either from local, Fairtrade or organic sources? In the last year, have you been registered in a CSA or farm-to-table program?

0%	No
1-25%	No
1-25%	No
1-25%	No
1-25%	Yes
26-50%	No
26-50%	Yes
26-50%	No
26-50%	No
51-75%	No
51-75%	Yes

APPENDIX G: MATERIALS AND PRODUCTS

PM1

Buildings being retained and repurposed: Zibi has committed to retaining and repurposing 50% of the buildings on site. While several buildings on site are protected by municipal law due to their heritage value, retaining these buildings also allows for Zibi to celebrate the rich industrial history of the site. Unfortunately, retaining aged and in most cases unmaintained buildings bring forth challenges associated with structural integrity and energy efficiency once repurposed, not to mention the financial implications associated with these activities. As such, Zibi undertook an extensive study to assess the retention and reuse feasibility of buildings on site. Buildings protected by law for their heritage value as well as those planned for retention are highlighted in the figures below.

Figure 1: Buildings to be retained in Gatineau highlighted in red.

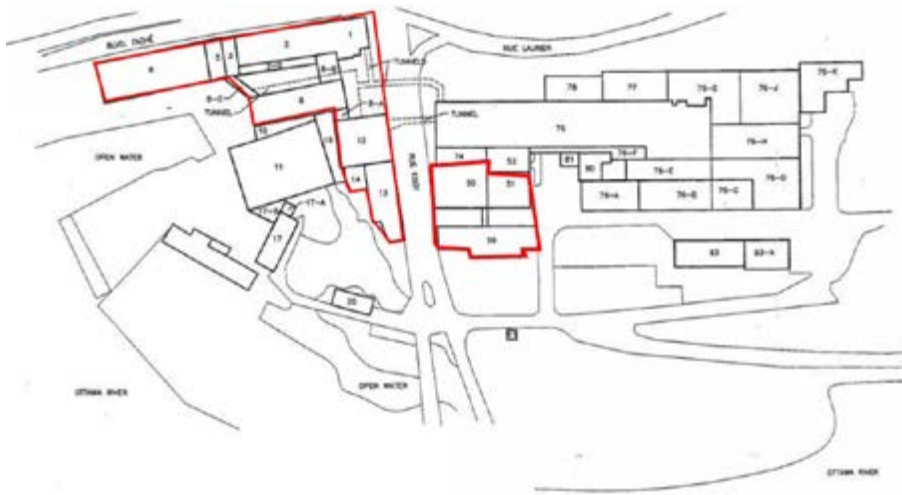
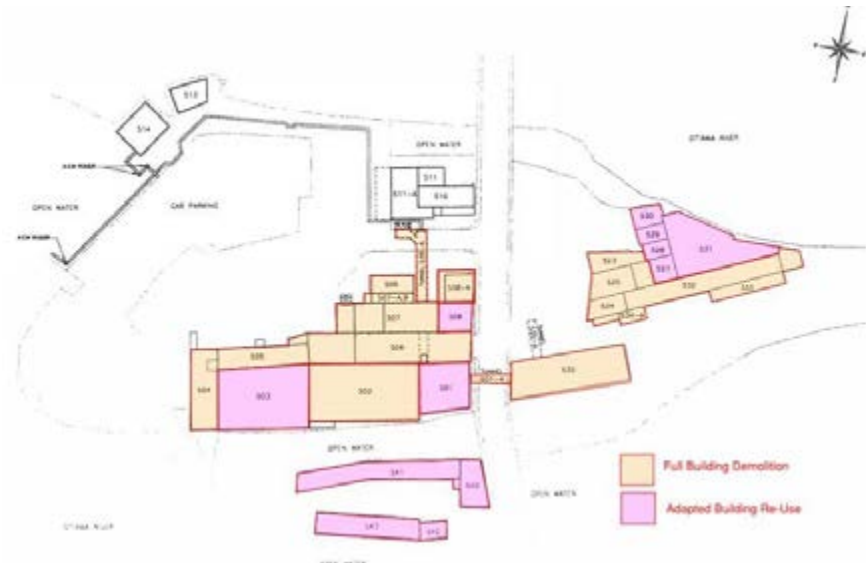

Figure 2: Buildings to be retained in Ontario highlighted in pink.



PM2

Table 1: Waste management on site.

Contaminated concrete generated from the site (Dec 2018 – April 2019) (generated and hauled to landfill in accordance to applicable MECP requirements, and O. Reg. 347)	12,500MT	0% reused
Mixed demolition waste/general debris (i.e. roofing materials, insulation, etc.)	113 MT	10% landfill
Steel sorted and hauled to the recycling facility (AIM Ottawa East Recycling facility). Segregated on-site and hauled to the appropriate recycling facility for reuse purposes.	979 MT	90% recycled

Based on the above, 90% of the total waste materials generated during the demolition program were recycled and/or re-used (diverted from landfill disposal), which excludes the contaminated concrete that was not eligible to be used as inert fill for the site. This is slightly below the 95% target for re-use and/or recycling established by ZIBI for the site. However, based on EXP's regular site inspections, we confirm that the demolition contractor made every effort to maximize the quantity of recyclable material via adequate segregation from the non-recyclable material. Furthermore, it is considered likely that the target was not met due to the unanticipated amount of contaminated concrete compared to the original estimates of clean vs contaminated concrete. It is also noted that a total of approximately 44 MT of asbestos-containing materials was disposed of as part of the pre-demolition abatement program. This amount was not included in waste totals since asbestos is considered hazardous waste and it is not eligible for re-cycling/reuse.

For comparison purposes, the pre-demolition waste audit estimate and the actual waste generated at the completion of the demolition program were compared. As mentioned previously, the waste audit completed in 2018 by EXP had estimated that approximately 16,494 MT of waste was to be generated from the demolition of buildings. However, the values estimated in the waste audit were below the 13,591 MT provided by Demo Plus (added total of the contaminated concrete, mixed demolition waste/general debris sent to landfill disposal, and the steel material recycled).

PM3

Table 2: Total % Post-Industrial Recycled Material Content in Block 301 concrete.

Tomlinson Ready Mix total quantity	Total % Post-Industrial Recycled Material Content
1290.5m3	34.34%

PM4

Table 3: Zibi Plaza FSC wood content.

FSC Wood	\$212,061.43
Reclaimed Wood	\$2,908.40
Other wood	\$0.00
Total wood	\$214,969.83
Total FSC Wood	100%

PM4

Table 4: Block 2 FSC wood content.

Wood supplies	\$314,682.75
FSC Wood	\$109,697.43
Other Wood	\$0.00
Total wood	\$424,380.18
Total FSC Wood	25.8%

Table 5: Total % Recycled Material Content in Block 2 concrete

Raw Material Sources	Total %
Post-consumer steel scrap	46%
Pre-consumer steel scrap	17%
Virgin iron ore	37%

APPENDIX H: ZERO WASTE

ZW4

Table 1: Summary of total construction waste diversion site-wide for 2019 demonstrating that Zibi diverted 99.1% of construction waste.

	Waste (MT)	Residual (MT)	Diversion rate (%)
Qc	8078.26	3.009	99.96%
ON	599.56	75.58	87.39%
Site-wide total	8677.82	78.589	99.09% (weighted average)

ZW4

Table 2: Construction waste diversion on Ontario site for 2019.

Date	Date	Box	Service bill	Weigh bill	Weight	Wood	Metal	Cardboard	Shingles	Gypsum	Insulating	Aggregate	Plastic	Waste	Total	Cumulative Total	Waste	Cumulative Waste	Recycled	
Livraison	Ramassé	#	#	#	tm	%	%	%	%	%	%	%	%	%	%	tm	tm	tm	%	%
30-Nov	11-Dec	2019	100724	147710	2.65	30	20	20			10		20		100	2.65	0	0	0%	100%
11-Dec	18-Dec	2128	100841	147722	3.29	60		20					10	10	100	5.94	0.329	0.329	6%	94%
18-Dec	09-Jan	2060	100943	147943	3.2	35	10	15		10	10	5	15		100	9.14	0	0.329	4%	96%
20-Dec	31-Jan	2005	100982	148346	3.3	20	15	15		20	10	5	15		100	12.44	0	0.329	3%	97%
09-Jan	28-Jan	2128	101067	148272	3.57	40	15	10		10	10		15		100	16.01	0	0.329	2%	98%
28-Jan	07-Feb	2108	101230	148456	3.87	10		50		10	5		25		100	19.88	0	0.329	2%	98%
31-Jan	12-Feb	2021	101268	148497	1.9	35	15	20		10	10		10		100	21.78	0	0.329	2%	98%
07-Feb	12-Feb	2123	101340	148493	2.86	20	15	15		10	15	10	15		100	24.64	0	0.329	1%	99%
12-Feb	19-Feb	2023	101373	148586	5.4	10		10			10	50	20		100	30.04	0	0.329	1%	99%
19-Feb	26-Feb	2118	101492	148684	3.33	30		40		5			25		100	33.37	0	0.329	1%	99%

▼ Chart continued on next page

Date	Date	Box	Service bill	Weigh bill	Weight	Wood	Metal	Cardboard	Shingles	Gypsum	Insulating	Aggregate	Plastic	Waste	Total	Cumulative Total	Waste	Cumulative Waste	Recycled	
Livraison	Ramassé	#	#	#	tm	%	%	%	%	%	%	%	%	%	%	tm	tm	tm	%	%
26-Feb	27-Feb	2127	101470	148704	3.55	20	10	20			20	5	25		100	36.92	0	0.329	1%	99%
27-Feb	08-Mar	2118	101510	148830	1.71	35	15	15	10		10		15		100	38.63	0	0.329	1%	99%
01-Mar	04-Mar	2037	101511	148760	2.51	40	10	20				20	10		100	41.14	0	0.329	1%	99%
04-Mar	14-Mar	2127	101540	148925	3.86	40	15	10			10	15	10		100	45	0	0.329	1%	99%
08-Mar	21-Mar	2103	101596	149034	3.64	40		20				30	10		100	48.64	0	0.329	1%	99%
14-Mar	22-Mar	2014	101660	149056	3.2	20	30	10					20	20	100	51.84	0.64	0.969	2%	98%
22-Mar	29-Mar	2104	101726	149145	4.17	5	5	20			40		30		100	56.01	0	0.969	2%	98%
12-Feb	08-Apr	2123	101374	149271	2.81	30	20			30			20		100	58.82	0	0.969	2%	98%
21-Mar	05-Apr	2053	101727	149263	2.1	30	15	15		10	10	5	15		100	60.92	0	0.969	2%	98%
29-Mar	17-Apr	2017	101798	149497	2.04									100	100	62.96	2.04	3.009	5%	95%
05-Apr	17-Apr	2023	101909	149480	4.3	20	10	20			20	10	20		100	67.26	0	3.009	4%	96%
17-Apr	13-May	2017	102007	149947	2.64	35	15	10		10	15	5	10		100	69.9	0	3.009	4%	96%
17-Apr	06-May	2104	102006	149958	2.72	30	15	15		10	10	5	15		100	72.62	0	3.009	4%	96%
06-May	13-May	2053	102200	149944	2.13	20	15	15		10	15	10	15		100	74.75	0	3.009	4%	96%
13-May	23-May	2018	102262	150148	2.57	40	10	15		10	10		15		100	77.32	0	3.009	4%	96%
23-May	31-May	2002	102379	150370	3.35	30	10	15		15	10	5	15		100	80.67	0	3.009	4%	96%
13-May	06-Jun	2053	102263	150485	4.47	30	15	15		10	10	10	10		100	85.14	0	3.009	4%	96%
23-May	03-Jun	2014	102392	150385	13.52							100			100	98.66	0	3.009	3%	97%
31-May	13-Jun	2052	102503	150659	3.69	35	15	10		10	10	5	15		100	102.35	0	3.009	3%	97%
06-Jun	26-Jun	1603	102566	150898	3.75	50	15	15					20		100	106.1	0	3.009	3%	97%
13-Jun	27-Jun	2129	102679	150914	3.49	75				5	5	15			100	109.59	0	3.009	3%	97%
26-Jun	12-Jul	1612	102790	151215	1.64	45	10	15		10	5	15			100	111.23	0	3.009	3%	97%
27-Jun	02-Jul	2021	102803	150970	2.19	10				70		10	10		100	113.42	0	3.009	3%	97%
02-Jul	11-Jul	2111	102817	151195	1.59	30	10	30				10	20		100	115.01	0	3.009	3%	97%
02-Jul	16-Jul	2021	102816	151278	2.81	60	10					10	20		100	117.82	0	3.009	3%	97%
12-Jul	17-Jul	1603	102977	151309	2.91	85	5					10			100	120.73	0	3.009	2%	98%
16-Jul	16-Aug	2127	102998	151815	3.94	40	20	5			5	30			100	124.67	0	3.009	2%	98%
16-Jul	13-Aug	2018	102999	151727	2.22	40	20	10					30		100	126.89	0	3.009	2%	98%
17-Jul	07-Aug	1613	103039	151629	1.24	30		30					40		100	128.13	0	3.009	2%	98%
13-Aug	20-Aug	2117	103275	151862	1.95	40		20			20		20		100	130.08	0	3.009	2%	98%

▼ Chart continued on next page

Date	Date	Box	Service bill	Weigh bill	Weight	Wood	Metal	Cardboard	Shingles	Gypsum	Insulating	Aggregate	Plastic	Waste	Total	Cumulative Total	Waste	Cumulative Waste	Recycled	
Livraison	Ramassé	#	#	#	tm	%	%	%	%	%	%	%	%	%	%	tm	tm	tm	%	%
20-Aug	27-Aug	2102	103348	152052	2.23	60	10	10				10	10		100	132.31	0	3.009	2%	98%
27-Aug	06-Sep	2120	103412	152211	2.66	40	15	20				5	20		100	134.97	0	3.009	2%	98%
06-Sep	13-Sep	2124	103488	152327	1.09	40	10	10				10	30		100	136.06	0	3.009	2%	98%
13-Sep	16-Sep	2119	103605	152351	2.33	50	20					10	20		100	138.39	0	3.009	2%	98%
16-Sep	23-Sep	2120	103627	152493	4.75	50	20	10				10	10		100	143.14	0	3.009	2%	98%
20-Sep	25-Sep	2105	103697	152520	4.12	100									100	147.26	0	3.009	2%	98%
23-Sep	30-Sep	2045	103700	152594	4.98	45	15	10				10	20		100	152.24	0	3.009	2%	98%
24-Sep	07-Oct	2039	103729	152706	2.78	40	15	10		5	15	5	10		100	155.02	0	3.009	2%	98%
30-Sep	07-Oct	2118	103774	152754	5.45	30	15	10		15	10	5	15		100	160.47	0	3.009	2%	98%
07-Oct	10-Oct	2039	103884	152785	5.3	30	10	10		20	10	5	15		100	165.77	0	3.009	2%	98%
07-Oct	23-Oct	2018	103883	152970	2.9	80					10		10		100	168.67	0	3.009	2%	98%
10-Oct	16-Oct	2123	103936	152830	1.79	35	10	15		10	10	5	15		100	170.46	0	3.009	2%	98%
16-Oct	21-Oct	2056	103976	152901	4.28	20	15	15		20	10	5	15		100	174.74	0	3.009	2%	98%
21-Oct	05-Nov	2014	104043	153237	3.71	20	10	20		30			20		100	178.45	0	3.009	2%	98%
23-Oct	07-Nov	2123	104073	153271	2.55	30	10	15		10	10	10	15		100	181	0	3.009	2%	98%
05-Nov	06-Nov	2045	104239	153257	3.31	20		10			50		20		100	184.31	0	3.009	2%	98%
06-Nov	12-Nov	2120	104255	153336	1.75	25	15	10		20	10	5	15		100	186.06	0	3.009	2%	98%
07-Nov	19-Nov	2002	104268	153429	3.49	25	15	10		15	10	10	15		100	189.55	0	3.009	2%	98%
12-Nov	18-Nov	2109	104295	153420	2.94	20	15	15		20	10	5	15		100	192.49	0	3.009	2%	98%
18-Nov	20-Nov	2123	104372	153458	2.19	50	10	10			15		15		100	194.68	0	3.009	2%	98%
19-Nov	27-Nov	2102	104388	153563	3.02	60		10			10	10	10		100	197.7	0	3.009	2%	98%
20-Nov	21-Nov	2034	104394	153473	2.31	15	10	10		25	10	15	15		100	200.01	0	3.009	2%	98%
21-Nov	22-Nov	2009	104413	153505	2.94	25	15	20		15	5	5	15		100	202.95	0	3.009	1%	99%
22-Nov	25-Nov	2120	104433	153519	1.54	15	15	10		20	15	10	15		100	204.49	0	3.009	1%	99%
25-Nov	27-Nov	2017	104444	153584	3.34	75	5				10		10		100	207.83	0	3.009	1%	99%
27-Nov	02-Dec	2106	104495	153654	1.95	35	10	15		10	10	5	15		100	209.78	0	3.009	1%	99%
27-Nov	03-Dec	2014	104473	153740	2.1	70	10	10					10		100	211.88	0	3.009	1%	99%
02-Dec	05-Dec	2105	104531	153771	2.39	55	25	10			10				100	214.27	0	3.009	1%	99%
03-Dec	13-Dec	2056	104541	153892	1.58	50	40						10		100	215.85	0	3.009	1%	99%
05-Dec	13-Dec	2128	104582	153901	2.5	60	10	10			10		10		100	218.35	0	3.009	1%	99%

APPENDIX I: ZERO CARBON

ZC3

Table 1: Total reused and hauled rock amount site-wide.

	Horizontal infrastructure	Vertical infrastructure	Total	
Kept, crushed or removed, and kept in stockpiles or reused as backfill	13850 m3	12740 m3	26590 m3	87.00%
Hauled offsite and tipped to landfill	4000 m3	0 m3	4000 m3	13.00%
Site-wide total	8677.82	78.589	99.09%	

